



# VTP 403



## DATA SHEET



rev. 1.1  
11 February 2021

## Operator panel with integrated PLC

- Relay or static outputs
- High speed (2 msec. standard cycle time)
- Contact programming with Ladder language
- Function for Recipe management, Step Motor, P.I.D. Regulator, Print etc ...

Kernel Sistemi  
Kernel Sistemi s.r.l., via Vignolese n. 1138  
41126 Modena - ITALY  
Tel. 059 469 978 - Fax 059 468 874  
[www.kernelgroup.it](http://www.kernelgroup.it)

## INDEX

<b>1</b>	<b>HARDWARE CHARACTERISTICS.....</b>	<b>3</b>
1.1	Electric Characteristics.....	3
1.2	Mechanics Characteristics.....	4
1.3	Rear View.....	4
1.4	Side View.....	5
1.5	Inputs and Outputs : VTP_403 R.....	6
1.6	Inputs and Outputs : VTP_403 S.....	7
1.7	Serial Ports.....	8
1.8	Analogic.....	8
<b>2</b>	<b>CONTACTS.....</b>	<b>9</b>

# 1 HARDWARE CHARACTERISTICS

This chapter describes the hardware characteristics of VTP\_403 :

## 1.1 Electric Characteristics

ELECTRIC CHARACTERISTICS	
Power supply voltage	24 Vdc +/- 10 %
Maximum Permitted Power Supply	27 Vdc
Current Consumption	Under 150 mA without loads
Microprocessor	Hitachi H8S/2145B @ 20MHz
Program Memory	64 KByte
Pages Memory	64 KByte
EEprom	16 KByte
Cycle Time	Programmable (min 1 msec.)
Digital Inputs	14 digital inputs PNP at 24 Volts of which 4 fast input (5 KHz for encoder reading) with programmable anti-noise filter (value 1 ... 16)
Analog Inputs	4 configurable analog inputs with 10 bits resolution [0 ... 1023] : → 2 inputs for voltage, current, PT100 or TMC → 2 inputs only for voltage or current
Digital Outputs	10 outputs : 8 PNP static 24 V and 500 mA [S] OR relay outputs [R] + 2 static out at 1.0 A
Analog Outputs	2 analog outputs 0...10 V with 8 bits resolution [0...255]
Plugged RAM	79 words any 100 msec automatically copy into plugged RAM (for a term of 1 year)
RTC	External real time clock with plugged calendar and clock with rechargeable battery (for a term of 1 year)
Current analog input Impedance	250 Ohm
Voltage analog input Impedance	10 KOhm
Serial Lines	2 Serial Lines (COM 0 and COM 1 )  COM 0 : It could be used in RS232, RS485 or RS422 with many different standard communication protocols for connect other devices (I/O expansions , thermoregulates inverters or network connection)  COM 1 : It is RS232 or RS485 mode and it's use like COM0 , besides for upload applications or operative system
ETH	No
Mini USB	No
USB Pendrive	No

### 1.2 Mechanics Characteristics

MECHANICS CHARACTERISTICS	
Temperature Range	From -10 ^C to +70^C
Humidity Range	From 10 % to 90 % (non-condensing)
Operating Atmosphere	Without corrosive gas
Noise Immunity	According to rules in force
Fixing System	4 M4 pegs
Weight	736 g
Keyboard	Membrane keyboard on anodized aluminium front part with 8 function buttons (from F 1 to F 8) and 6 dedicated buttons
Display	Alphanumeric display 20 characters on 2 rows, with led's backlight 8 leds on function buttons and one alarm led On demand available also Cyrillic Display
Break Size	144x96 ; Depth 71 mm
Front Size	168x125 mm

### 1.3 Rear View

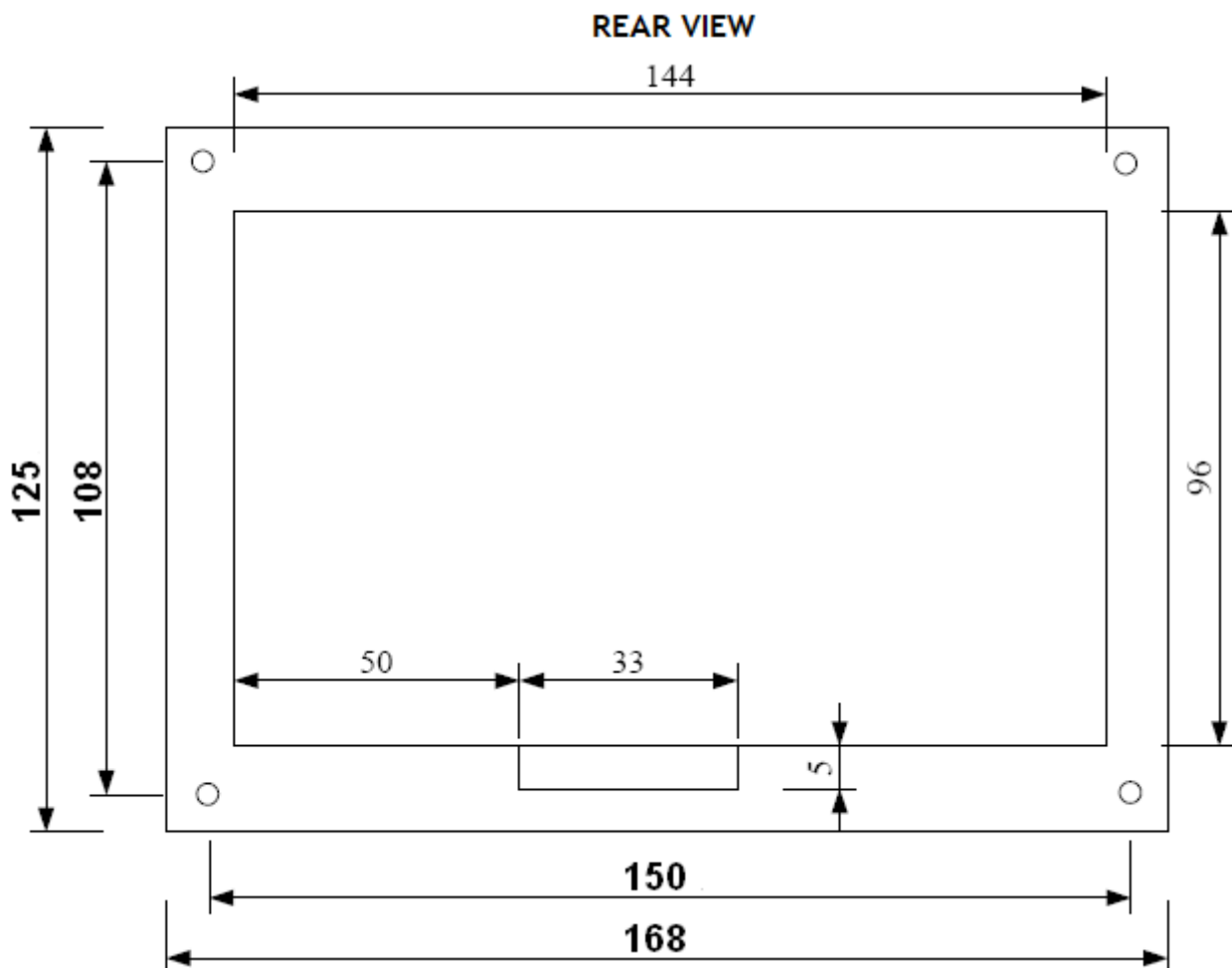

1.4 Side View

SIDE  
VIEW

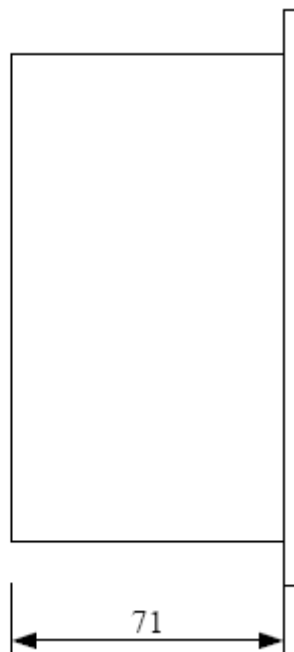

1.5 Inputs and Outputs : VTP\_403 R

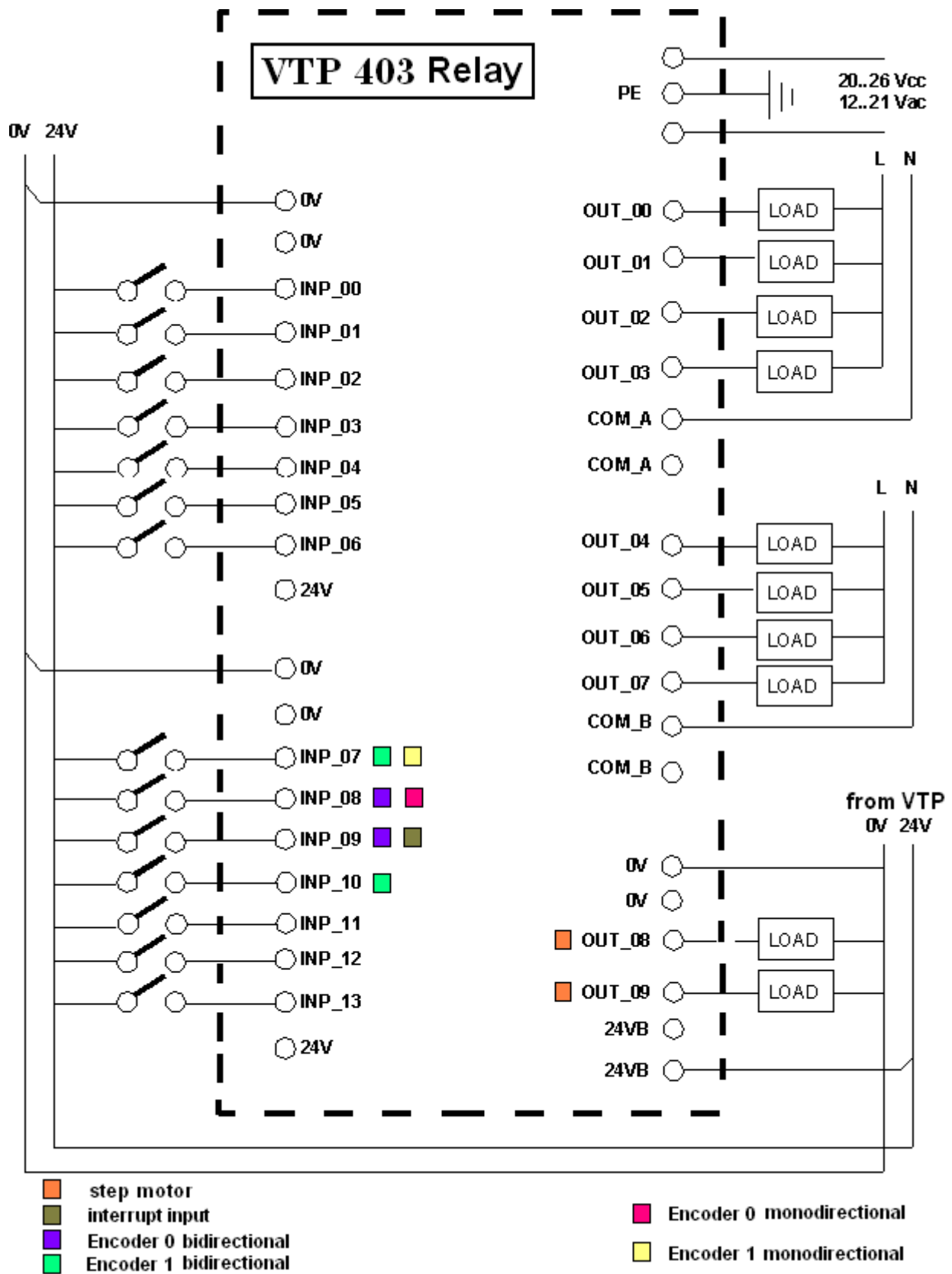

1.6 Inputs and Outputs : VTP\_403 S

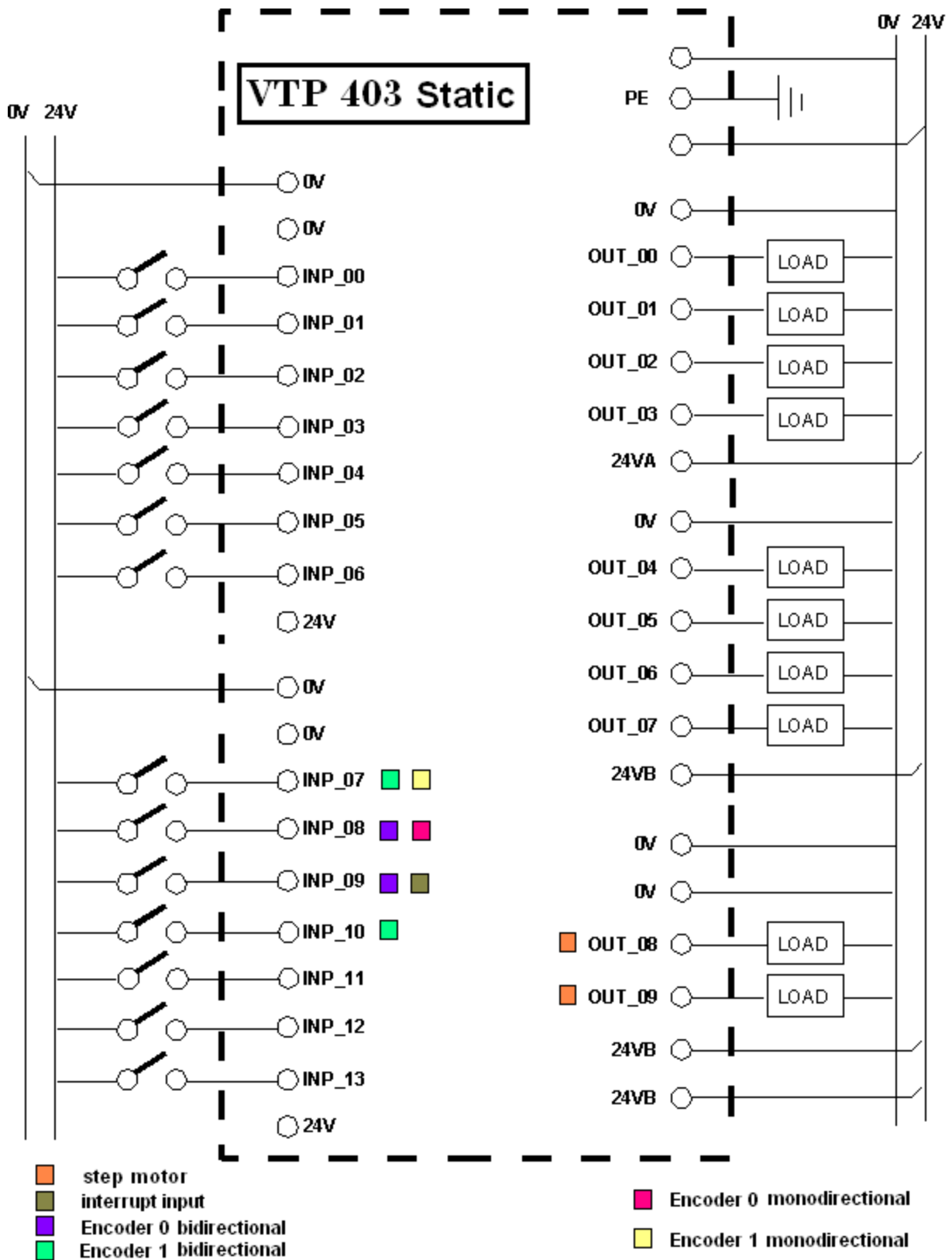

1.7 Serial Ports

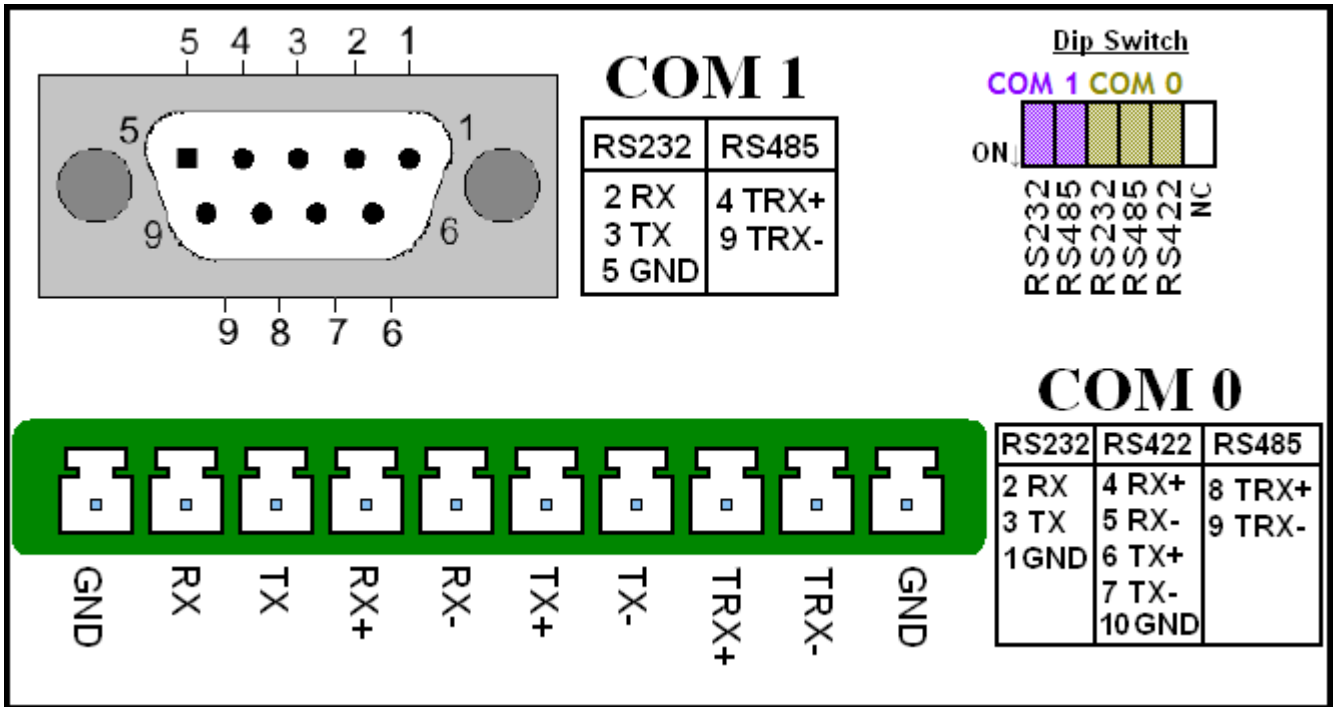

1.8 Analogic

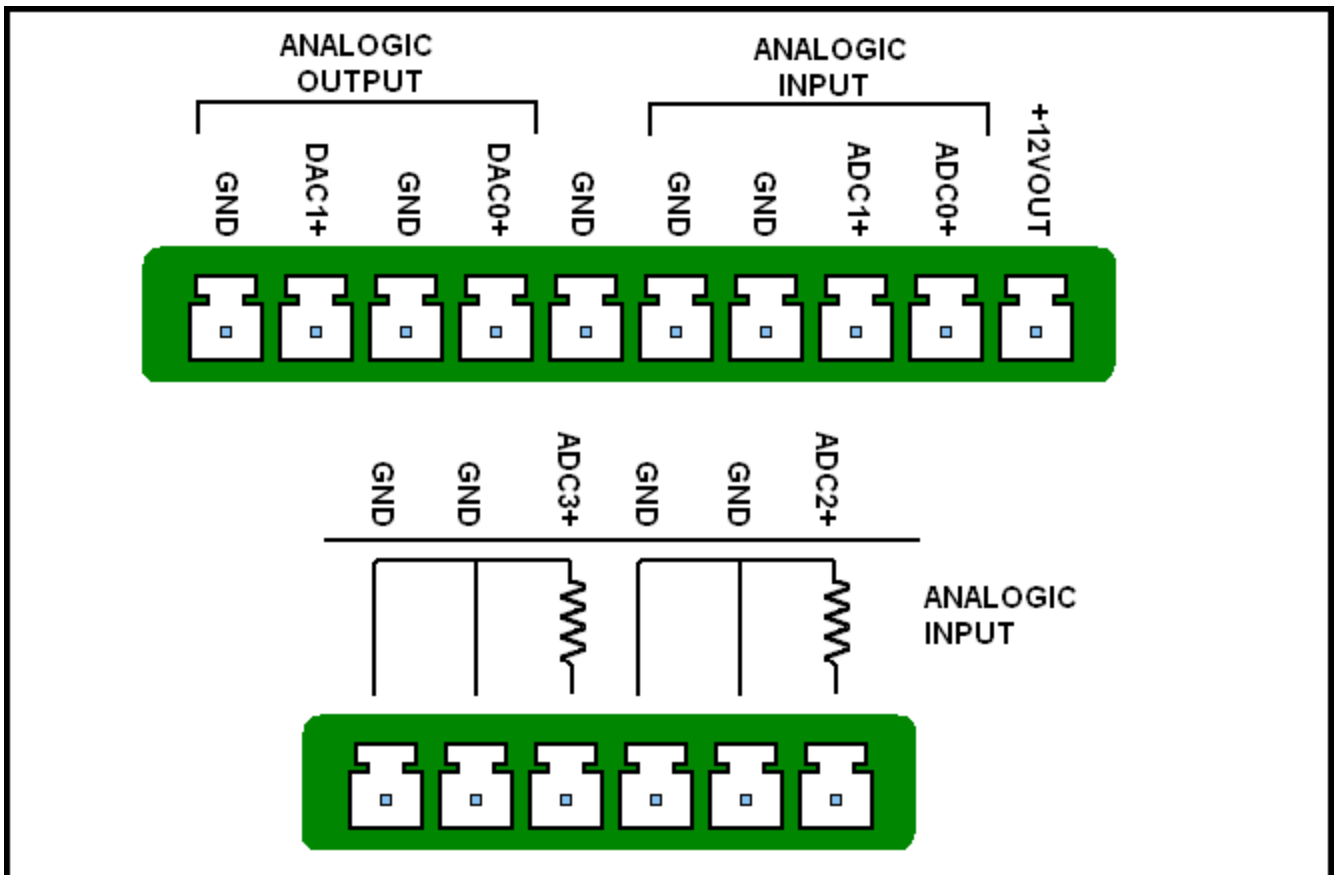



## 2 CONTACTS

### GENERAL

Tel: 059 469978  
website: [www.kernelgroup.it](http://www.kernelgroup.it)  
e-mail: [info@kernelgroup.it](mailto:info@kernelgroup.it)

### COMMERCIAL

Sig.ra Linda Mammi  
Tel: 059 469978 Int. 207  
e-mail: [sales@kernelgroup.it](mailto:sales@kernelgroup.it)  
Skype: mammi.kernel

### ADMINISTRATION

Sig.ra Paola Morandi  
Tel: 059 469978 Int. 201  
e-mail: [amministrazione@kernelgroup.it](mailto:amministrazione@kernelgroup.it)  
Skype: morandi.kernel

### PURCHASING and PRODUCTION

Sig. Stefano Catuogno  
Tel: 059 469978 Int. 204  
e-mail: [produzione@kernelgroup.it](mailto:produzione@kernelgroup.it)  
Skype: catuogno.kernel

### TECHNICAL OFFICE

Sig. Alessandro Muratori  
Tel: 059 469978 Int. 205  
e-mail: [alessandro.muratori@kernelgroup.it](mailto:alessandro.muratori@kernelgroup.it)  
Skype: muratori.kernel

Support  
Tel: 059 469978 Int. 209  
e-mail: [support@kernelgroup.it](mailto:support@kernelgroup.it)  
Skype: support.kernel

Sig. Morisi Luca  
e-mail: [luca.morisi@kernelgroup.it](mailto:luca.morisi@kernelgroup.it)  
Skype: morisi.kernel

Kernel Sistemi s.r.l. , via Vignolese n. 1138  
41126 Modena - ITALY  
Tel. 059 469 978 - Fax 059 468 874  
[www.kernelgroup.it](http://www.kernelgroup.it)